

An aerial photograph of a large, historic stone and timber house with a large lawn and a river. The house features a prominent gabled roof with multiple chimneys and a mix of stone and timber cladding. A large, well-maintained lawn is in the foreground, bordered by a stone wall and a river. The property is surrounded by lush green trees and a dense forest in the background. A dirt driveway leads to a smaller building and a white van. A white car is parked near the main house. The sky is blue with scattered white clouds.

Howard Morley
& Sons

PER MONTH

£10,000 Per Month

Mill Lane

Godalming, GU8 5AH

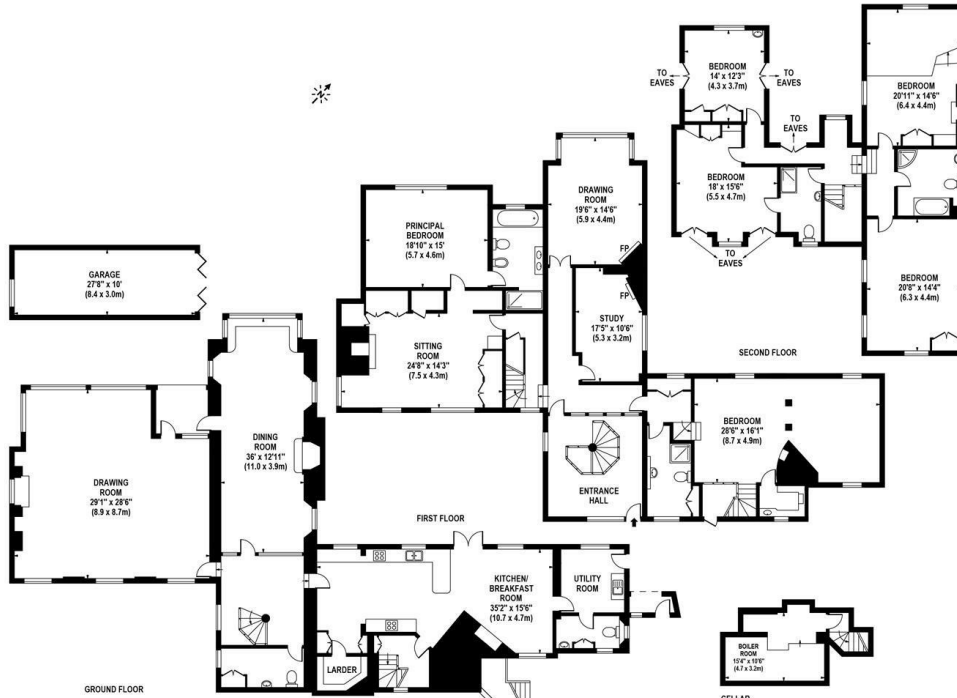

Energy Efficiency Rating		Current	Potential
Very energy efficient - lower running costs			
(92 plus)	A		
(81-91)	B		
(69-80)	C		73
(55-68)	D		
(39-54)	E	40	
(21-38)	F		
(1-20)	G		
Not energy efficient - higher running costs			
England & Wales		EU Directive 2002/91/EC	

Agents Note: Whilst every care has been taken to prepare these particulars, they are for guidance purposes only. All measurements are approximate and are for general guidance purposes only and whilst every care has been taken to ensure their accuracy, they should not be relied upon and potential buyers/tenants are advised to recheck the measurements

Howard Morley
& Sons

OFFICE ADDRESS
276 High Street
Guildford
Surrey
GU1 3JL

OFFICE DETAILS
01483 575 304
lettings@hmorley.co.uk
hmorley.co.uk